

Using the controller with a sensor head and switches

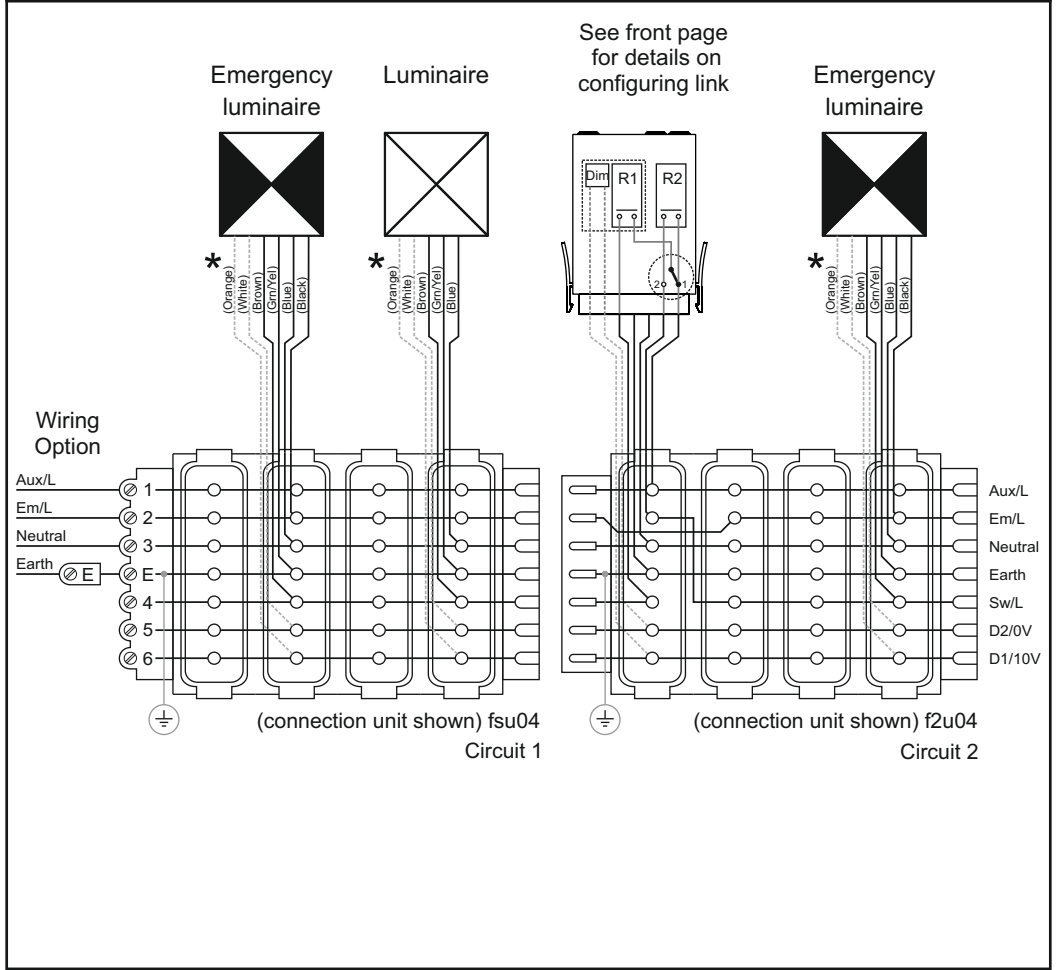

fnc4000(D,X or A)/AB/2 Controllers

Includes Additional Switch Circuit

The fnc4000(D,X,A)/AB/2 is a control device that plugs directly into a special type of connection unit; the f2u--. Working with switches or together with a plug-in sensor head, the device can control two switching circuits ON and OFF. The exact operation will depend on which, if any, sensor head is fitted. Note that any connected switch or sensor head will be operating at ELV.

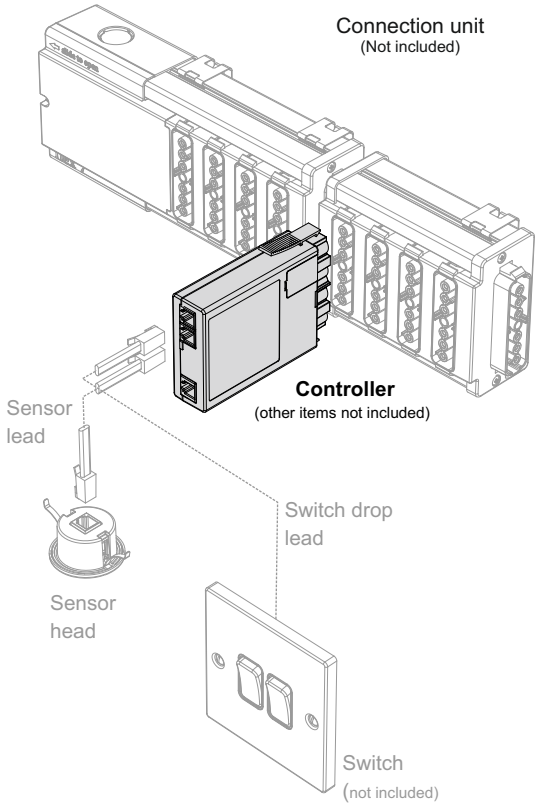

Three products are available:
 fnc4000D/AB/2 : DSI dimmable ballasts.
 fnc4000X/AB/2 : DALI dimmable ballasts.
 fnc4000A/AB/2 : Analogue ballasts 0-10V.

Please ensure the correct product is selected for the type of ballast being used as incorrect connection may damage the controller.

This product should only be installed by a qualified electrician.

Supply Voltage	:Nominal 230V~ 50Hz	Max No. DALI	:up to 25 drivers
Type	:Class 2		
Material	:PA6 UL94 V-0 rated, Non-halogen		
Operating range	: -10°C to 40°C		
Total Load	:10A		
Switched Load	:6A		
Peak Inrush	:120A (duration <20mS)		
IP Rating	:IP20		
Compliance	:2014/35/EU		
	:2014/30/EU		

Configuring the fnc4000(D,X,A)/AB/2/L controller

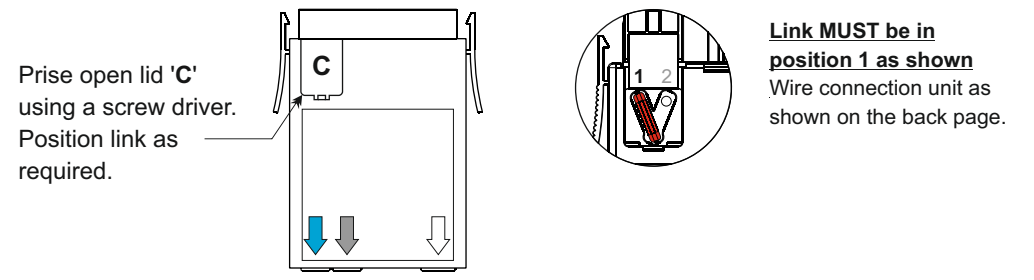

Using a fnc4000(D,X or A)/AB/2 controller with a switches only

* Refer to leaflet *Networking Sensors*, leaflet number 17/245.

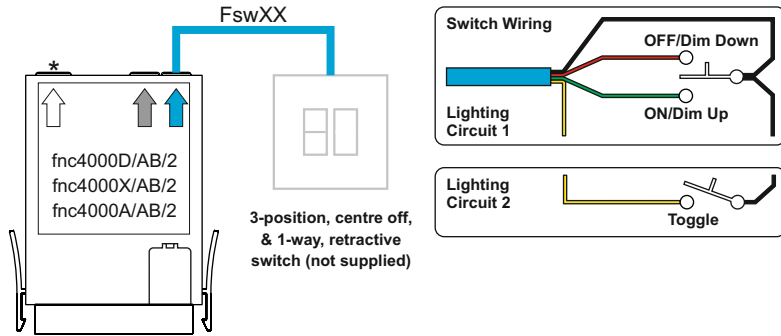

Operation:

Switch control:

Lighting Circuit 1:

ON pulse - turns the lights ON (to the last dimmed level).
 OFF pulse - turns the lights OFF.
 A long ON pulse - brightens lights (eventually to maximum).
 A long OFF pulse - dims lights (eventually to minimum, but should the pulse exceed 15 secs the lights will switch OFF completely).

Lighting Circuit 2:

Pulse - toggles the lights ON or OFF.

Note:

Multiple switches can be connected in parallel. 'Y' connectors are available to enable two switch drop leads to be connected into one point. (Part No. fsy/A - adaptor)

Using the controller with a sensor head and switches

* Refer to leaflet *Networking Sensors*, leaflet number 17/245.

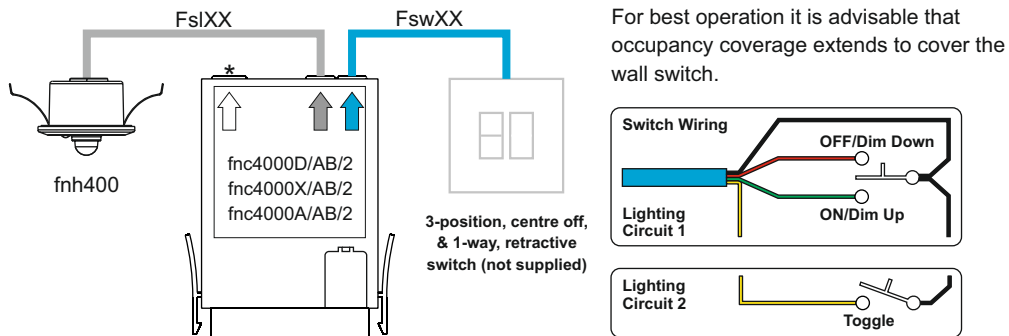

Note:

Multiple switches can be connected in parallel. 'Y' connectors are available to enable two switch drop leads to be connected into one point. (Part No. fsy/A - adaptor)

Note: Alternative operational options not necessarily shown above are available using the frc/set setup remote control.
 Full instructions for setting up the sensor are supplied with the sensor head and the frc/set remote control - both ordered separately.

Operation:

Switch control:

Lighting Circuit 1:

ON pulse - turns the lights ON with *daylight linking* activated.
 OFF pulse - turns the lights OFF.
 A long ON pulse - brightens lights (eventually to maximum).
 A long OFF pulse - dims lights (eventually to minimum, but should the pulse exceed 15 secs the lights will switch OFF completely). Additionally, if the lights are subsequently dimmed up or down by the switch, *daylight linking* will be deactivated in preference to the DIM state attained by the switch.

Lighting Circuit 2:

Pulse - toggles the lights ON or OFF.

Absence detection:

When occupancy is no longer detected, lights (both lighting circuits) will switch OFF after a pre-selected *time-out* period (default 20 minutes).

Daylight linking: Provided *daylight linking* is activated (see switch control above) the light output will adjust to compensate for any changes in ambient light in order to maintain a constant light level under the sensor head - the *target level*.