

flex7 Occupancy Sensor Heads

flex7 Standard Occupancy Sensor Heads

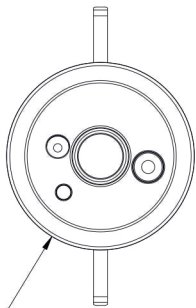

Suitable for snapping into a 32mmØ cutout.

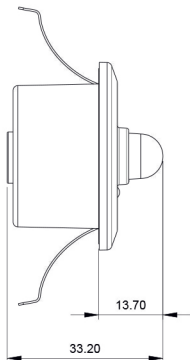

flex7 Tamper-resistant Occupancy Sensor Heads

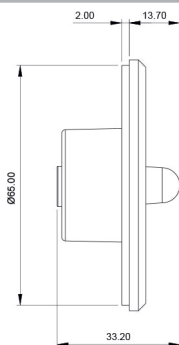
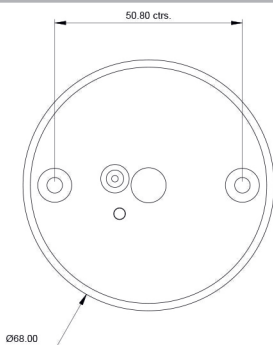

All measurements are in millimetres

Rating

Supply Voltage: 12V DC

Manufactured in white PA6 UL94 V-0 rated, Non-halogen

Conformity: LVD-2006/95/EC: EMC-2004/108/EC

Operating range: -10 to 40°C

Sensor Range: 7.42m x 5.66m at 2.5m height

Detection Zone

The X-Y cross-sectional diagram shows the detection zone patterns indicate the projections of the 16 lenses with a single focal point. Movement of an object with higher than background temperature, between the detection zones, will be detected.

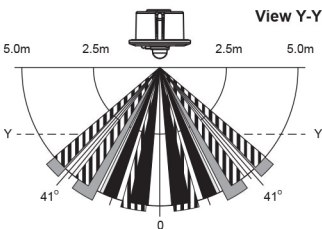
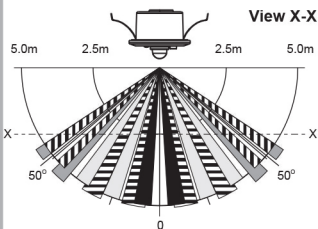
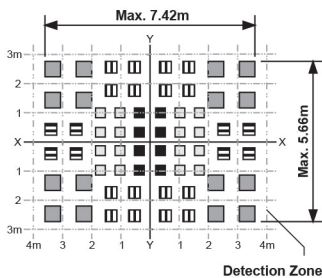

fnh200, fnh400 & fnhslave

